

Challenger Lifts



Model#: CL4P9X

Home/Commercial Storage 4-Post Lift
9,000 lb. lifting capacity
Storage Application



AUTOMOTIVE SPECIALTY EQUIPMENT
1-800-366-0328
www.AutomotiveEquipment.BIZ

Home Enthusiast Lifts

**Do It Yourself & Light-Duty
Commercial Service**

Challenger's CL4P7 7,000 lb. capacity and CL4P9 9,000 lb. capacity 4-post lift was designed with versatility in mind. From home enthusiast and commercial storage applications to light duty general service applications, these lifts compliment your service needs and are loaded with real benefits. They are essential for the "do it yourself" home garage, providing the best of both worlds - store a vehicle up top and below with up to 80" of clearance when the lift is fully raised, or use this lift to service your vehicles.



Multiple Power Unit Locations

The power unit can be placed either on the front column of the drivers side or the back column of the passenger side of the lift. This provides convenient power control accessibility and versatility for any garage layout.



Features & Benefits:

- Heavy-duty commercial grade design with rigid formed columns and runways for superior strength and dependability, yet light enough to move around the garage (with optional caster set)
- 115v standard plug-in power unit with optional 220v version available
- Versatile design allows it to be either Free-Standing or Bolt-to-Floor
- Built-in runway rail system accommodates optional rolling jacks, jack trays, drip trays, and storage platforms
- Single hydraulic cylinder protected under neath runway
- Large molecular composite slider blocks for minimal wear and maximum dependability

Storage/Light Duty Service Lift

Challenger's 7,000 lb. capacity CL4P7 and 9,000 lb. capacity CL4P9S, CL4P9X and CL4P9W are perfect for home garage and commercial storage and light duty general service applications. Bolt it down or leave it free standing so you can relocate it anywhere. With extended length and width models, these service and home storage units provide unlimited options for the DIY car enthusiast.

With optional rolling jacks, ramp upgrades, oil drain pan, etc., you'll be able to accommodate just about anything that comes in your garage and afford room to grow with its reasonable cost. Available in black only.

Storage Application

It's the best of both worlds. Service your vehicles or store them up top. With 80" rise height, most full size vehicles are easily parked underneath for everyday use. Optional drip tray set completes the storage application, keeping any fluids from contacting the vehicle underneath.

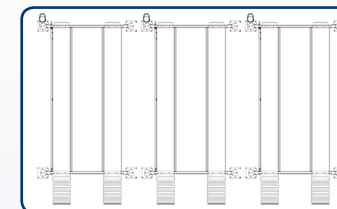

Multiple unit storage lifts available with full CAD layout support

Service Application

Professional grade quality with 80" high rise and multiple lock positions is perfect for light duty service up to 9,000 lb. capacity. Optional rolling jacks and jack trays provide quick tire and brake work access.

Optional Accessories

RJ4.5:
4,500 lb. Capacity Rolling Jack



RJ04-PK:
Air/Hydraulic Pump Kit.

CL4P9SR:
Bolt-on steel and hinged Approach Ramps with wheel stop

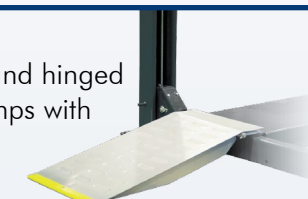

CL4P9ER: 50" Optional Extended Aluminum Ramps



CL4P9DTP: Plastic Drip Tray Set (set of 4)



CL4P9DT: Drip Tray Set (set of 3)

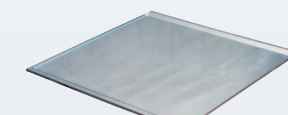

CL4P9JT: 4,500 lb. capacity Jack Tray



CL4P9CS: Caster Set (set of 4)

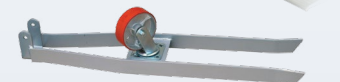

Model	CL4P7	CL4P9S	CL4P9X	CL4P9W
Lifting Capacity	7,000 lbs. (3175 kg)	9,000 lbs. (4082 kg)		
A Length Overall	16' 3 1/2" (4966mm)	17' 5 1/2" (5321mm)	19' 5 1/2" (5931mm)	
B Width Overall	8' 4 1/2" (2553mm)	9' 4 1/4" (2851mm)		10' 7 1/4" (3232mm)
C Inside Columns	92 1/8" (2340mm)	95" (2413mm)		110" (2794mm)
D Between Columns	147 1/2" (3747mm)	160 1/2" (4077mm)	184 3/4" (4993mm)	
E Height of Columns	6' 7 1/2" (2019mm)	7' 1/2" (2146mm)	8' 1/2" (2451mm)	
F Height of Runways	5 3/4" (146mm)	7" (152mm)		
G Width of Runways	20" (508mm)	20" (508mm)		
H Width Between Runways	38" (965mm)	38" (965mm)		
I Rise Height	68 1/8" (1731mm)	73 1/4" (1861mm)	85 1/2" (2172mm)	
Max. Wheelbase*	141 1/2" (3594mm)	155" (3937mm)	179" (4547mm)	179" (4547mm)
Crossbeam Clearance Height ¹	63" (1600mm)	68" (1727mm)	80" (2032mm)	80" (2032mm)
Motor	1 HP	1 HP		
Voltage (1 Phase Std) ¹	115v	115v		
Speed of Rise ¹	120 Seconds	120 Seconds		
Min. Recommended Bay Size	10' x 20' (3048mm x 6096mm)	11' x 22' (3353mm x 6707mm)	11' x 22' (3353mm x 6707mm)	14' x 22' (4267mm x 6707mm)

* Maximum wheelbase is based on a tire diameter of 30"

¹ Optional 220v power for 60 second rise time available. Must be specified at time of order. Available in Black only.

² Height to bottom of crossbeam measured with lift sitting in highest lock position

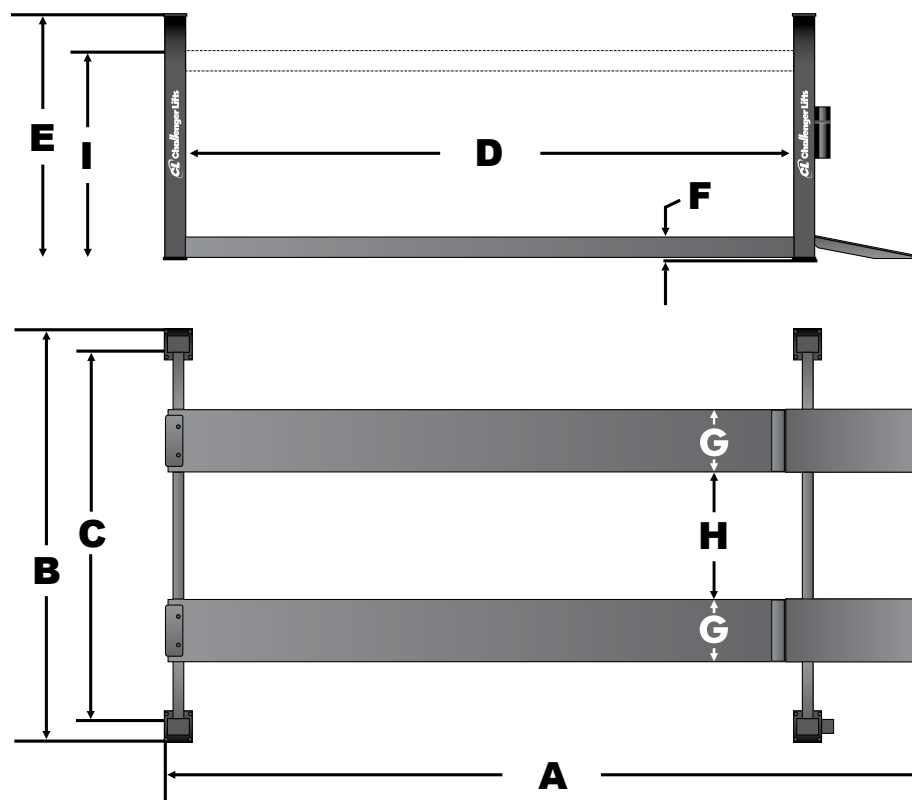

The Automotive Lift Institute (ALI) certifies that the CL4P9H, CL4P9X and CL4P9W described herein comply with the applicable provisions of the American National Standards ANSI/ALI ALCV 2011 and are Third Party Validated by the ETL Testing Laboratory.

CHALLENGER LIFTS, INC.
200 Cabel Street
Louisville, Kentucky 40206

Phone Toll-Free: 800-648-5438
502-625-0700

Fax: 502-625-0711

E-mail: sales@challengerylifts.com

Challenger Lifts, Inc. reserves the right to make changes to specifications without notice and without making changes retroactive. Unloading, installation and oil not included.